

FMC-07



Installation Manual

Floor Mounting Cart

FMC-07 Installation manual

- To ensure using the stand correctly and safely, please read this manual carefully before installation.
- This model is recommended to be used for 55-86 inch interactive flat panel.
- Maximum load capacity: 100KG.

● Bill of materials:

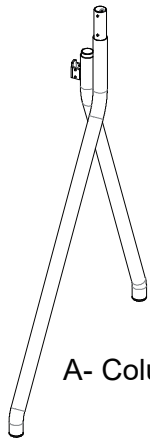

A- Column (L) x1

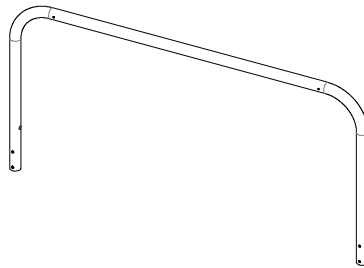

C- Big U tube x1

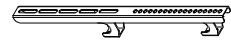

E- Mounting Patterns x2

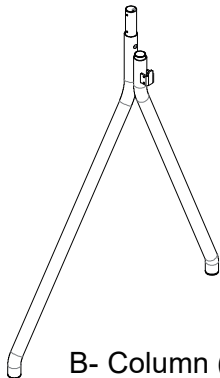

B- Column (R) x1

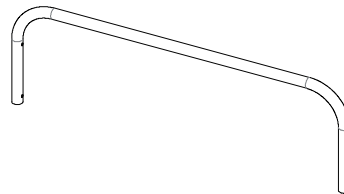

D- Small U tube x1



F- Caster x4 (with brake)

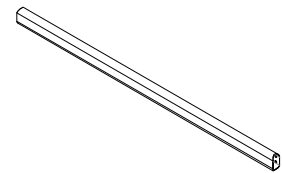

G- Horizontal tube x1

Other accessories (in mm):

H- Screw	M6 × 12	10pcs	
J- Screw	M8 × 45	4pcs	
K- Screw	M8 × 25	4pcs	
L- Hexagon wrench	4 mm	1pcs	
Q- Tray		1pcs	
P- Open end wrench	19 mm	1pcs	

Step 1 : Assemble the Horizontal tube between the two columns.

Caution: no need to screw firmly, for a convenient subsequent assembly.

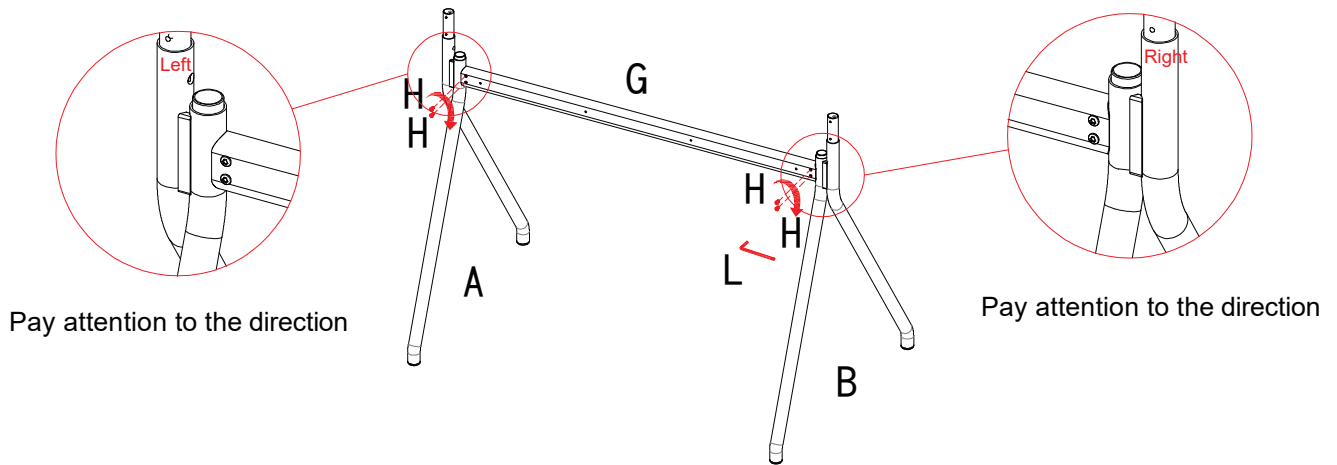

Figure 1

Step 2 : Assemble the Big U tube between the two columns.

Caution: no need to screw firmly, for a convenient subsequent assembly.

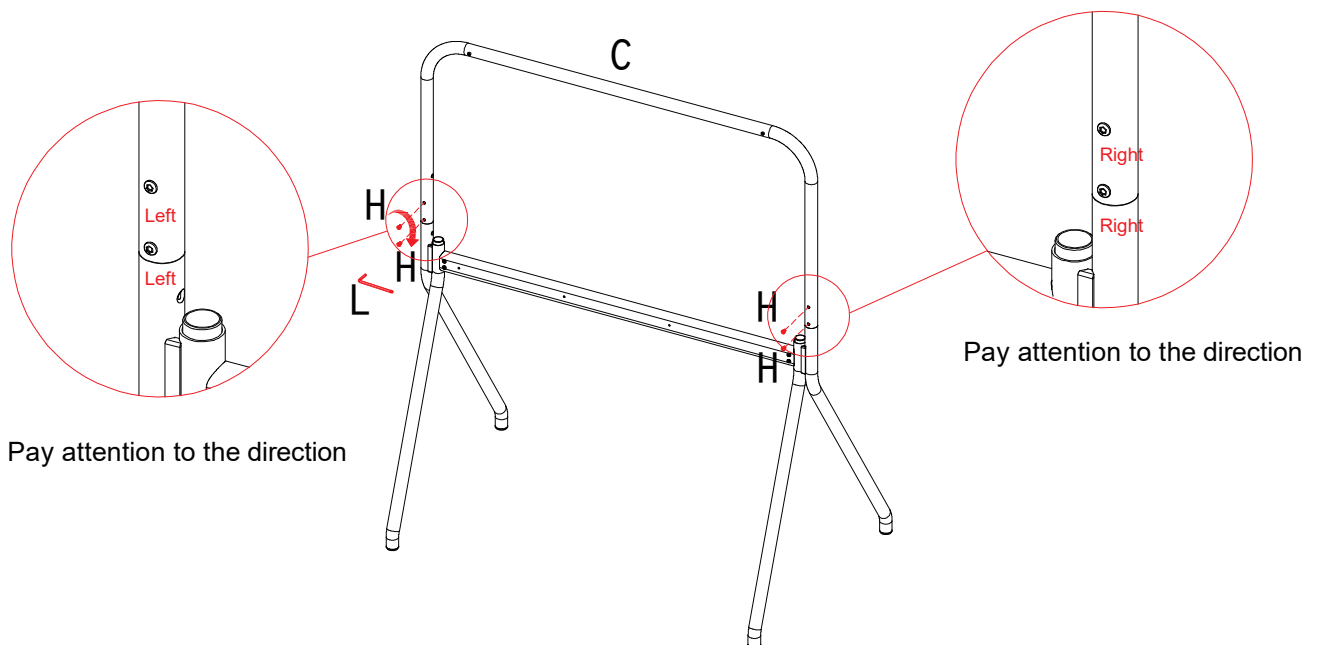

Figure 2

Step 3 : Assemble the Small U tube between the two columns.

Caution: no need to screw firmly, for a convenient subsequent assembly.

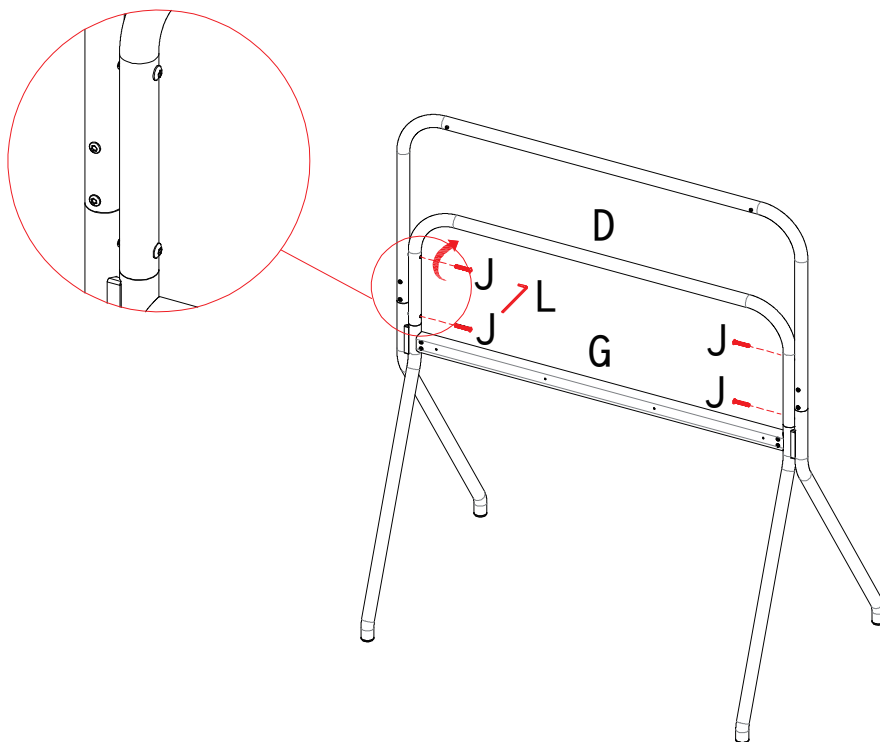

Figure 3

Step 4 : Caution: make sure the cart is put on the level ground, each component is on the right position. Then tighten the screws in sequence.

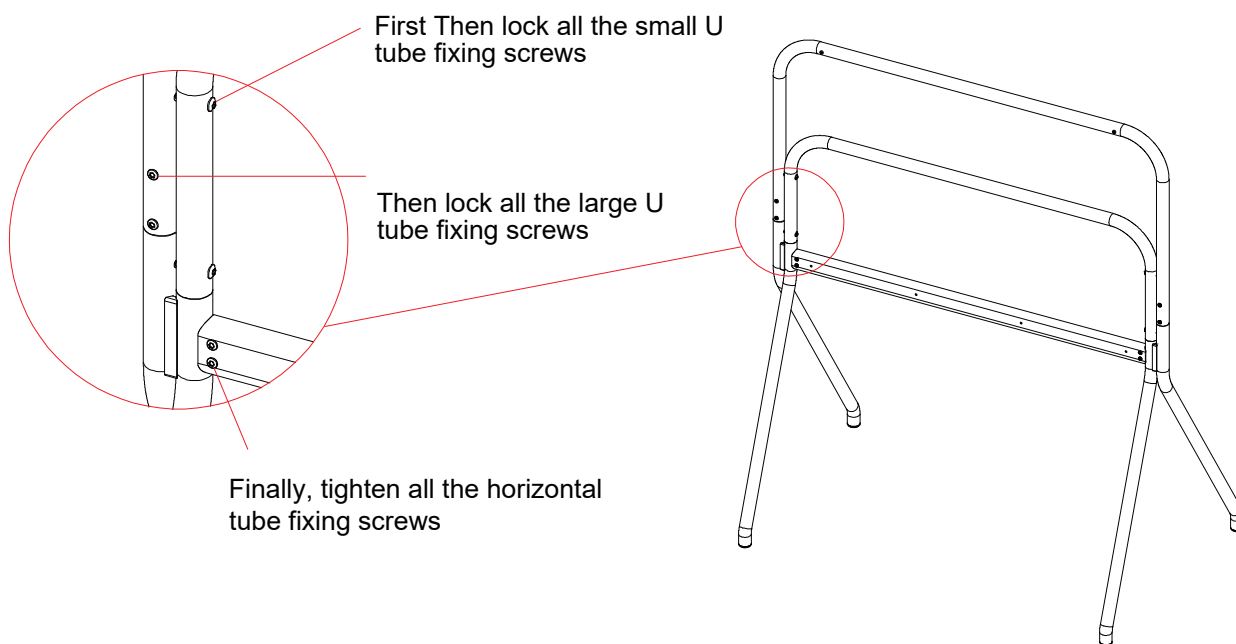

Figure 4

Step 5 : Adjust the wheel to the brake state and screw it into the leg.

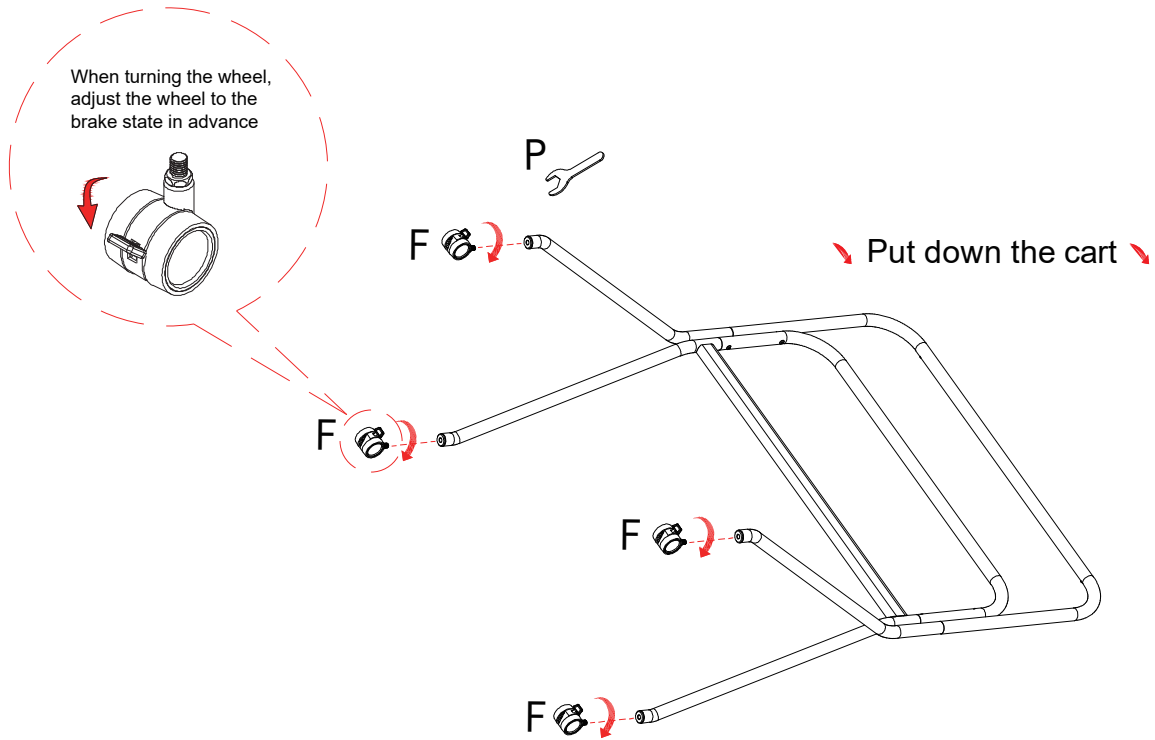

Figure 5

Step 6 : According to the actual requirements of the whole machine, lock the wall hanging strip on the whole machine.

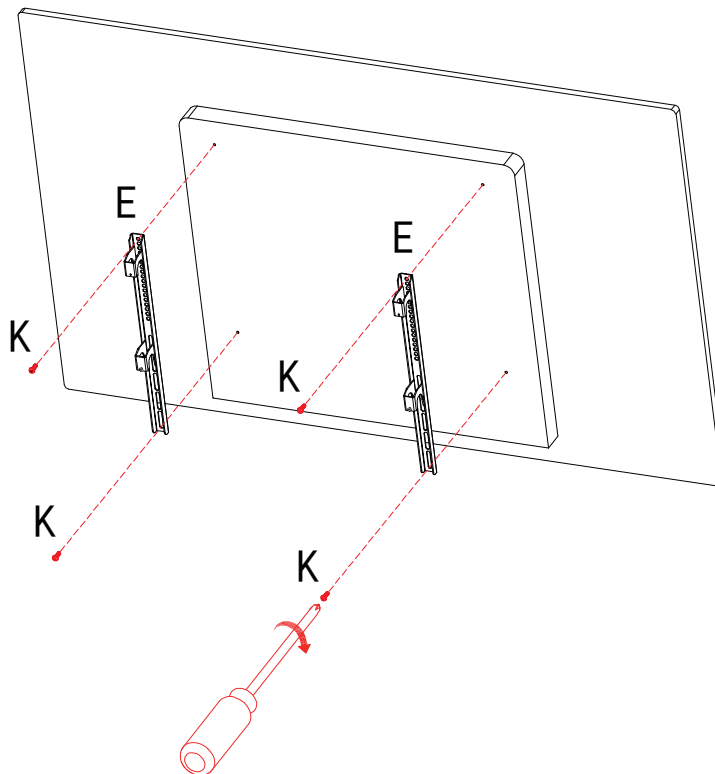
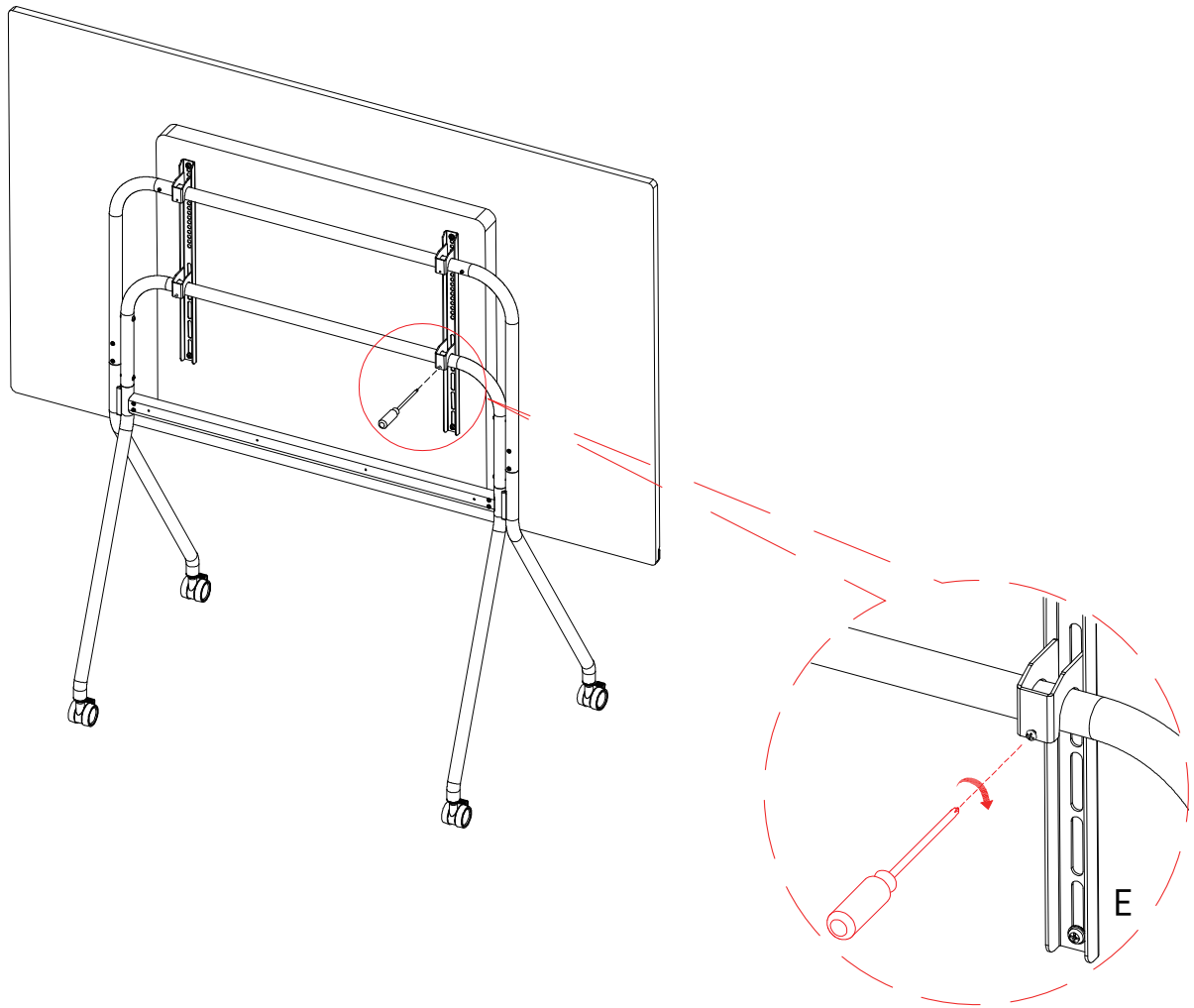

Figure 6

Step 7 : The assembled machine will be hung on the wall bracket and the safety screw of the wall hanging strip will be locked.



Please use Mounting Patterns in the mobile bracket packing box
Tighten the screws by cross screwdriver after TV interface installation

Figure 7

Step 8 : Optional tray assembly.

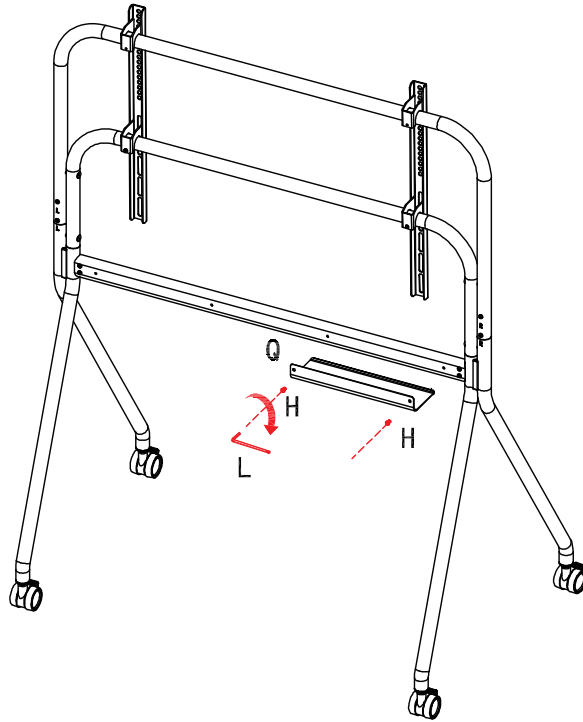

Figure 8

Step 9 : The mounting position of the tray is adjustable.

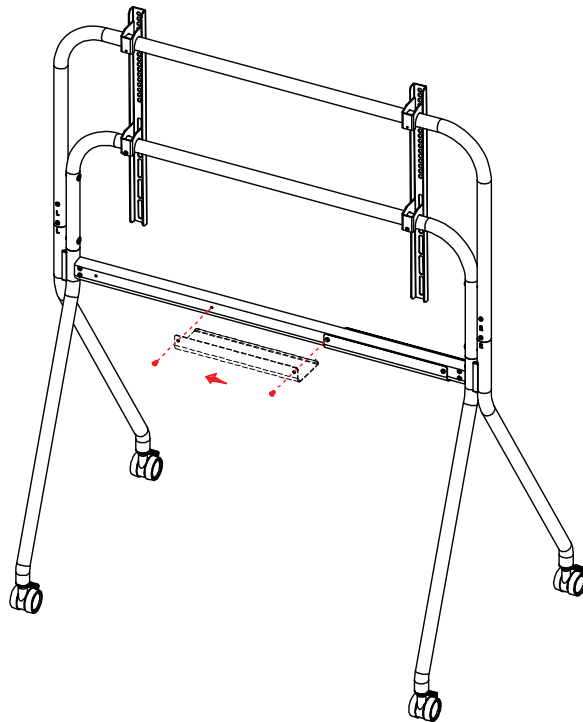

Figure 9

Step 10: After the assembly is completed, refer to the figure below.

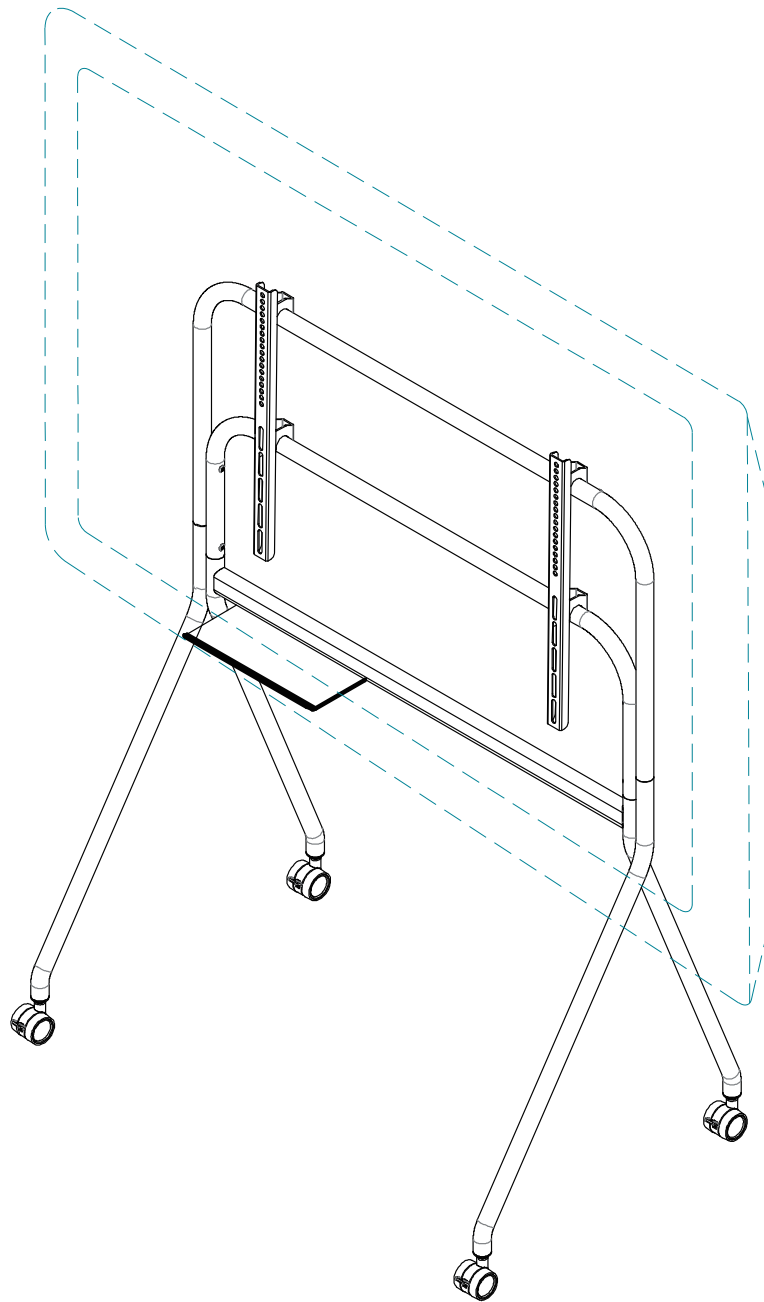

Figure 10